

Flange information Flange Size Flange Type (e.g. ANSI) Flange Rating (e.g. 150#)	Removal Size (Micron or MM)
Flange Finish 120 Grit sanding disc (Standard) Machined serrated spiral Machined concentric	Material 304 Stainless Steel 316 Stainless Steel 316L Stainless Steel
Flow Direction (see drawing) Direction A Direction B	Are Material Certificates required? No Yes
Open Area Ratio to Nominal Pipe Area (O.A.R.) >100% open or free area >150% open or free area >200% open or free area >250% open or free area >300% open or free area Please confirm using custom dimensions provided or Refer to - Dimensions Option 1	Number of units required? Qty Notes

MONARCH
INDUSTRIAL PRODUCTS

Cone

QUOTE REQUEST

Please Complete, save file and return to
sales@monarchindustrial.com.au

www.monarchindustrial.com.au Phone: 07 3889 9949

Contact Name:	
Company:	
Email:	
Phone:	

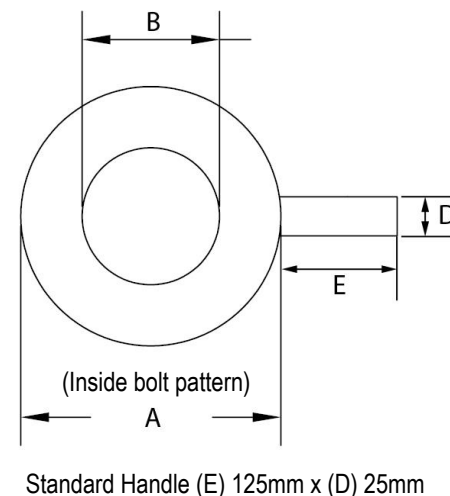
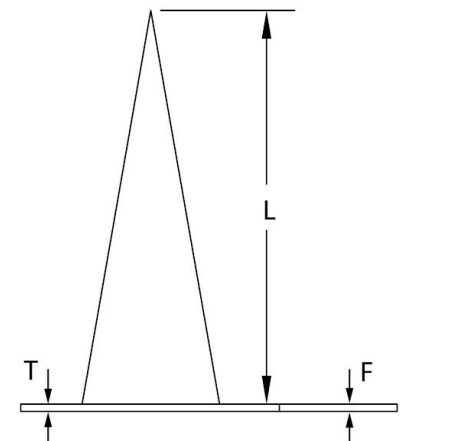

Flow Direction

Direction A
(Inside to Outside)

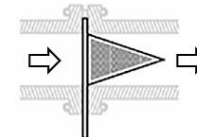

Direction A
(Outside to Inside)

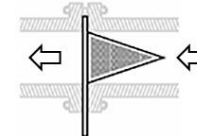

Dimensions

Option 1: to be completed by customer or
 Option 2: to be completed by Monarch

Option 1: Custom Dimensions

To be completed by Customer	A	mm
	B	mm
	L	mm
	T	mm
	F	mm
	E	mm
	D	mm
(T) Standard is 3mm		

or

Option 2: Dimensions as calculated

To be completed by Monarch	A	mm
	B	mm
	L	mm
	T	mm
	F	mm
	E	mm
	D	mm

Monarch Ref Information

Document:	REF-0011-Cone
Date:	
Quote Ref.	
Dwg No.	